

## Dust Contact Prevention Model

# *TFP* SERIES

Prevent scatter of dust particles and ensure worker's safety

Prevent contact with dust particles while filter replacement



## ■ Specifications

Model		TFP-0201	TFP-0202	TFP-0302	TFP-0303	TFP-0402	TFP-0403
Filter	Area(m <sup>2</sup> )	13.5	27	40.5	60.8	54	81
	Shape	Molded cartridge					
	Quantity	2	4	6	9	8	12
Filtration Air Velocity (m/min)/(f/min)		Max 1.5/5					
Compressive strength (kPa)		-4.5					
Dust off	Method	Pulse Jet(Fixed Interval)					
	Pilot Valve (Quantity)	2	2	3	3	4	4
	Compressed Air Consumption (L/min)	20	30	45	50	60	70
Inlet Size	(in)	φ 7.7	φ 9.84	φ 11.8	9.84 × 19.68	9.84 × 15.75	9.84 × 27.56
	(mm)	φ 200	φ 250	φ 300	250 × 500	250 × 400	250 × 700
Outlet Size (mm)		φ 200	φ 290	φ 350	φ 450	φ 380	φ 500
Power Cord (m)		None					
W × D × H	(in)	29.4 × 44.5 × 97.3	42 × 44.5 × 101.3	42 × 44.5 × 116.2	54.6 × 44.5 × 126.8	42 × 44.5 × 126.8	54.6 × 44.5 × 142
	(mm)	747 × 1130 × 2472	1067 × 1130 × 2572	1067 × 1130 × 2952	1387 × 1130 × 3222	1067 × 1130 × 3332	1387 × 1130 × 3602
Weight (kg)/(lbs)		210/462	270/594	320/704	450/990	370/814	500/1100
Hopper Capacity (L)		55	108	108	230	108	230
Allowable suction air temperature (°C)/(°F)		40/104					
Coating color		JPMA J11—833					

※Listed figures apply to standard specification only. Those figures may change depending on custom requirements.

## ■ Feature

Filter Change

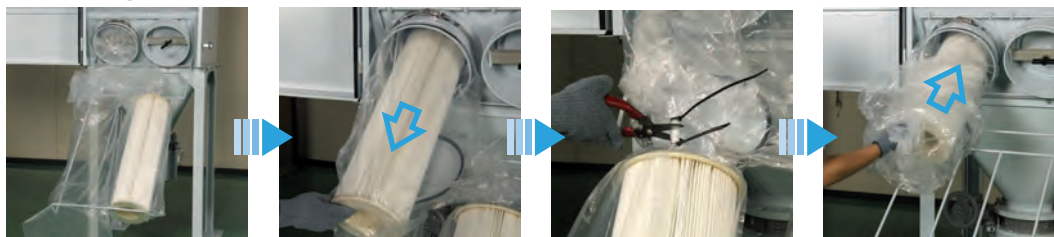

Powder Discharge



### For Your Safety

- Be sure to read the instruction manual thoroughly before getting started, and use the machine correctly.
- Do not suction the following materials:
  - Explosive materials... aluminum, magnesium, titanium, zinc, epoxies, etc.
  - Flammable materials... gasoline, thinner, benzene, kerosene, paint, etc.
  - Sparks... sparks, or dust that contains sparks
  - Fire remains... cigarette stubs, ashes, etc.
  - Other... water, oil, liquid chemicals, etc.
- If there is a danger of suctioning sparks when collecting flammable dust from polishing work and so forth, consult with your branch or sales office to select the appropriate model.
- This product is not an explosion-proof type. Do not install the machine at hazardous areas specified by laws.
- Do not operate the machine in areas exposed to mist, fumes or gases that are inflammable, explosive or corrosive.
- Please comply with regulations stipulated by laws and/or ordinances that are applicable to product installation.
- Be sure to ground the machine to protect against electric shock.
- Be sure to use pipes with the appropriate diameter and make them as short as possible according to dust collection conditions so that dust will not accumulate in them.
- Please perform daily and periodical maintenance work in accordance with instructions described in the operation manual. Please comply with regulations stipulated by laws and/or ordinances that are applicable to product maintenance.
- The pictures shown in this catalog may differ slightly from the actual products.
- Please dispose of collected powder particles and used filters appropriately in accordance with your own regulations and/or applicable laws.
- The filter pack and the liner pack are sealed with a banding band. Please note that the sealing method is not a seal welding and therefore, they are not completely sealed up.
- Please consult with us about product specifications etc if the machine is to collect hazardous powder particles.

Specifications and descriptions contained in this catalog may be subject to change without notice.

Please direct any questions to:

Digital data only

**AMANO Corporation**

275 MAMEDO-CHO, KOHOKU-KU, YOKOHAMA,  
JAPAN 222-8558  
TEL.+81-45-439-1508 FAX.+81-45-439-1150  
Website: <http://www.amano.co.jp/English/>